

# Cylindrical Type

# NAMUR

# 2-wire

Comfort series  
 5 mm embeddable  
 8 mm not embeddable

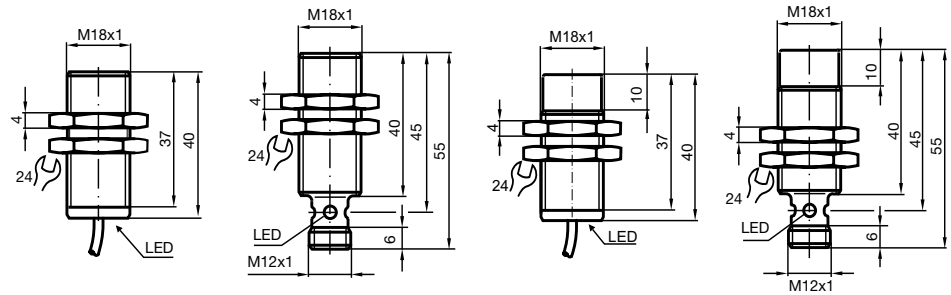

Rated operating distance $s_n$	5 mm	5 mm	8 mm	8 mm
Installation	embeddable	embeddable	not embeddable	not embeddable
NAMUR NC	<b>NCB5-18GM40-N0</b>	<b>NCB5-18GM40-N0-V1</b>	<b>NCN8-18GM40-N0</b>	<b>NCN8-18GM40-N0-V1</b>
Reduction factor $r_{V2A}$	0,74	0,74	0,72	0,72
Reduction factor $r_{AI}$	0,35	0,35	0,42	0,42
Reduction factor $r_{Cu}$	0,3	0,3	0,4	0,4
Assured operating distance $s_a$	0 ... 4,05 mm	0 ... 4,05 mm	0 ... 6,48 mm	0 ... 6,48 mm
Nominal voltage $U_o$	8 V	8 V	8 V	8 V
Current consumption				
Measuring plate detected	1 mA	1 mA	1 mA	1 mA
Measuring plate not detected	3 mA	3 mA	3 mA	3 mA
Switching frequency $f$	1000 Hz	1000 Hz	500 Hz	500 Hz
Indication of the switching state	all direction LED, yellow	ring LED, yellow	all direction LED, yellow	ring LED, yellow
EMC in accordance with	EN 60947-5-2	EN 60947-5-2	EN 60947-5-2	EN 60947-5-2
Standard conformity	DIN EN 60947-5-6	DIN EN 60947-5-6	DIN EN 60947-5-6	DIN EN 60947-5-6
Effective internal capacitance $C_i$	95 nF	95 nF	95 nF	95 nF
Effective internal inductance $L_i$	100 $\mu$ H	100 $\mu$ H	100 $\mu$ H	100 $\mu$ H
Ambient temperature	-25 ... 100 °C	-25 ... 100 °C	-25 ... 100 °C	-25 ... 100 °C
Protection degree	IP67	IP67	IP67	IP67
Connection type	2 m, PVC-cable	V1-connector	2 m, PVC-cable	V1-connector
Core cross-section	0,75 mm <sup>2</sup>	-	0,75 mm <sup>2</sup>	-
Housing material	high grade steel	high grade steel	high grade steel	high grade steel
Sensing face	PBT	PBT	PBT	PBT

### Connection:

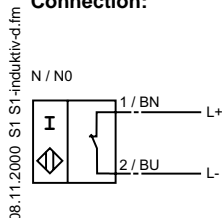

08.11.2000 St1-St1-induktiv-d.im

inductive proximity switches